

PARTS LIST BREAKDOWN C3M031-3

208/230 V - 1 Phase - 60 Hz

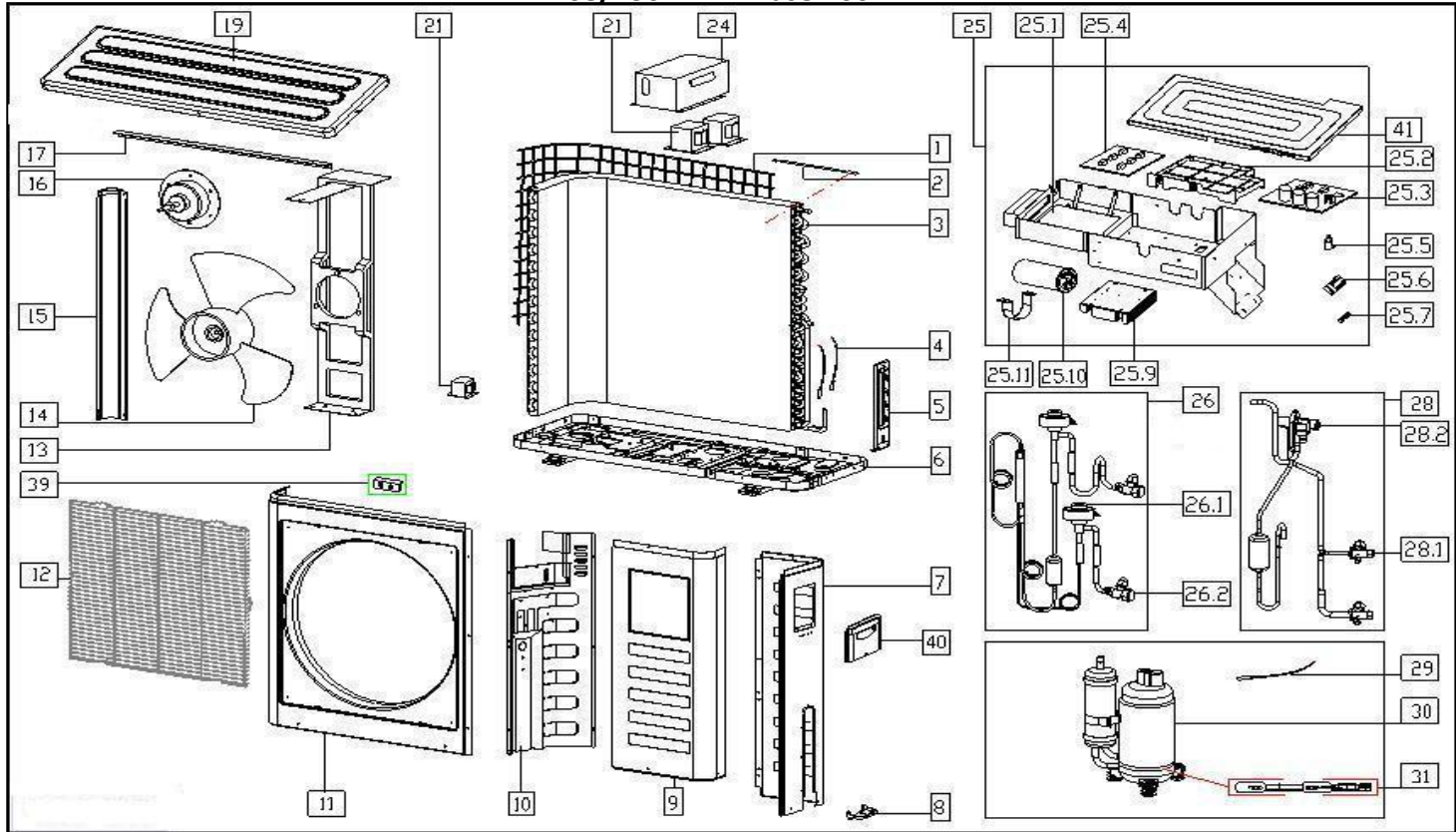

Item #	Part Description	Qty	Part No.	Comments	Updated Part No.
1	Rear net	1	B48100375		
2	Ambient temperature sensor assembly	1	M01310075		M01300196
3	Condenser assembly	1	E57190030		
4	Pipe temperature sensor assembly	1	N40500004		
4	Pipe temperature sensor assembly	1	M01300422		
5	Valve plate	1	B57190109		
6	Chassis assembly	1	B57090054		
7	Rear right clapboard assembly	1	B57190094		
8	Water collector	1	A37300183		
9	Front right clapboard assembly	1	B48100350		
10	Partition board assembly	1	B57190026		
11	Front panel	1	B48100356		

12	Air outlet grille	1	B37890112		
13	Supporter assembly of fan motor	1	B481G0039		
14	Fan Blade	1	A45500002		
15	Left supporter	1	B48100364		
16	Fan Motor	1	N00400955		
17	Rear net frame	1	B48100076		
19	Top cover assembly	1	B57190097		
21	Reactance	1	M01000818	R1815B	M01000910
21	Reactance	1	M01000832	R1325C	M01050025
21	Reactance	1	M01000814	R2503	M01000913
24	Cover of inductance	1	B48090001		
25	Electronic control box assembly	1	W571A0009		
25.1	Electronic control box	1	B57190050		
25.2	Installation plate of PCB	1	A57390005		
25.3	Main control board assembly	1	C571A0010		
25.4	Inverter control board assembly	1	C57190062		
25.5	Fan motor capacitor	1	N01100353		
25.6	Wire joint	2	M01450156		
25.7	Insulation plate	1	A57390004		
25.9	Radiator	1	M01990006		
25.10	Capacitor of compressor	1	N01000612		
25.11	Capacitor clip	1	B00100026		
26	Liquid valve assembly	1	F57190409		
26.1	Electronic expansion valve assembly	3	F01300554		
26.2	Liquid valve	3	F00740097		F00740100
28	Reversing valve assembly	1	F57190224		
28.1	Gas valve	3	F00720091		
28.2	Reversing valve	1	F00690011		
29	Discharge temperature sensor assembly	1	N48200000		
30	Compressor	1	D00600530		
31	Crankcase electric heater	1	N03100500		
39	Clamp of front net	8	A35110801		
40	Big Handle	1	B57190112		
41	Cover of electronic control box	1	B57090037		