

30" CLASSIC RANGE FEATURES AND SPECIFICATIONS

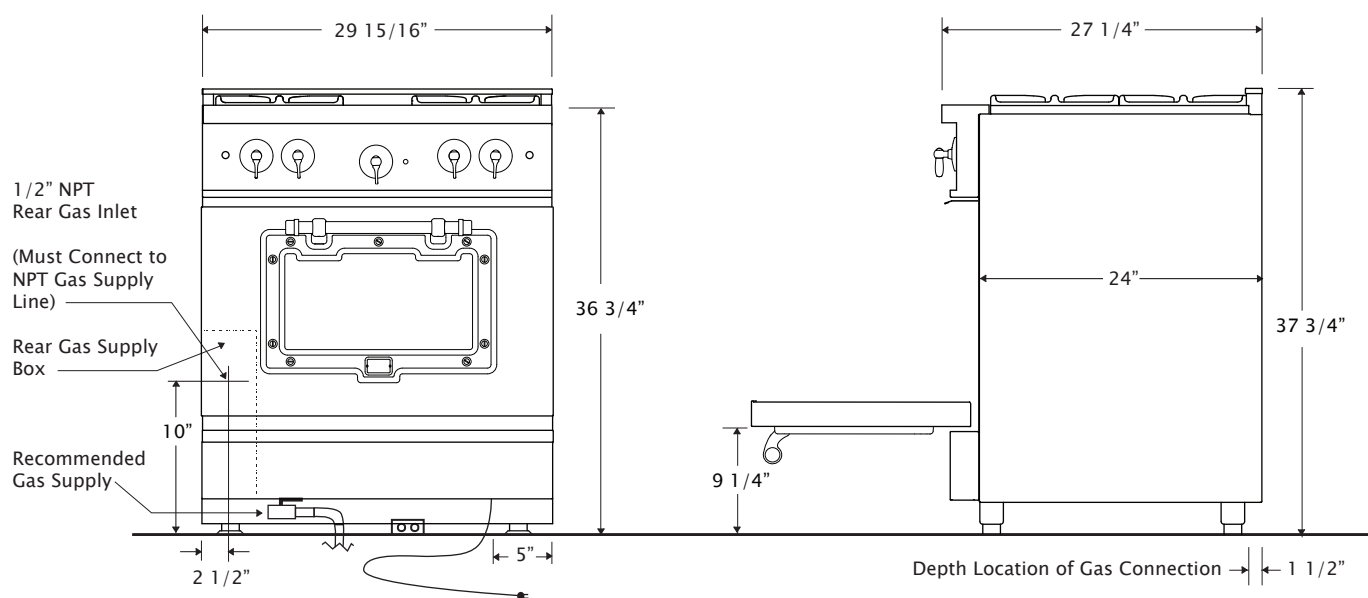

Front Burners	15-18,000 BTU	*Easy to clean Sealed Burner Top
Back Left Burner (Simmer)	6,000 BTU	*Automatic electronic ignition and re-ignition system
Back Right Burner	10,000 BTU	*24" depth for compatibility with standard kitchen cabinetry
Infrared Broiler Rating	15,000 BTU	*Convection fan
Oven Burner Rating	30,000 BTU	*Full Extension oven rack
Electrical Requirements	120 VAC, 15 Amps,	*Heavy-duty, commercial stainless steel construction
*(Unit must be on a non-GFI, dedicated outlet)	Single Phase	*2 Years Parts and Labor Warranty

Operating Gas Pressure	NAT: 5.0" WC
	LP: 10.0" WC
Install Clearance:	0" Side Cabinet
	0" Back Wall
	6" Side Wall

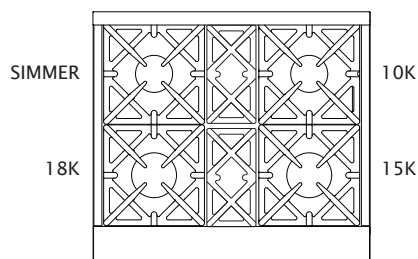

OVEN CAPACITY:

The cavity design of the oven provides the most precise temperature control, which delivers even heat distribution resulting in versatile performance. It has the largest oven capacity available on a 30" range and will accommodate a full-size commercial 18" x 26" baking sheet.

INFRARED BROILER:

Because of its popularity in the commercial market, the direct-fired ceramic infrared broiler is standard on all residential ranges. The large burner produces 1850 F of intense, searing heat close to the burner, while effecting a gentler broiling for foods placed farther away. The broiler is fully recessed into the oven's top to create maximum cooking space.

FULL MOTION GRATES:

Bring sauce to a boil while stirring on a front burner, then slide it to the rear to simmer while you saute up front! Our full motion grates allow you to easily reposition pots and pans from front to rear burners without lifting. The grates are also oversized to accommodate the largest stock pots and saute pans.

30" CLASSIC INDUCTION RANGE FEATURES AND SPECIFICATIONS

MODEL:
BCC130

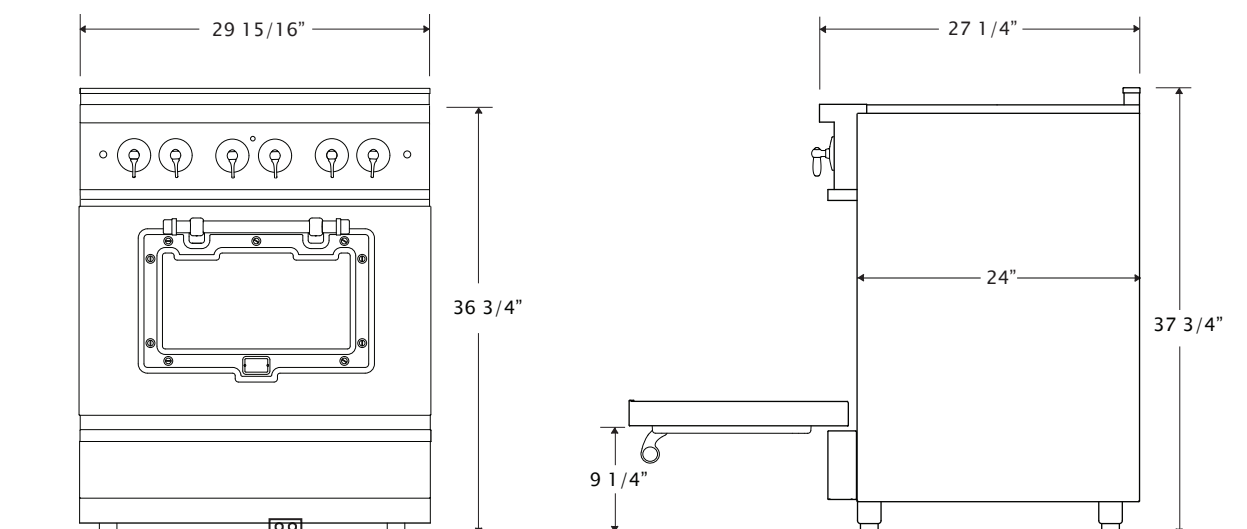

Front Left Burner	1850 Watts
Front Right Burner	1400 Watts
Back Left Burner	1850 Watts
Back Right Burner	2300 Watts
Broiler Element	2500 Watts
Oven Bake Element	2500 Watts
Oven Capacity	4 cu.ft.
Electrical Requirements	240 Volt, 60 Hertz,
*(Unit must be on a non-GFI, dedicated outlet)	50 Amp, Single Phase

*Easy to clean Sealed Burner Top

*Automatic electronic ignition and re-ignition system

*24" depth for compatibility with standard kitchen cabinetry

*Convection fan

*Full Extension oven rack

*Heavy-duty, commercial stainless steel construction

*2 Years Parts and Labor Warranty

OVEN CAPACITY:

The cavity design of the oven provides the most precise temperature control, which delivers even heat distribution resulting in versatile performance. It has the largest oven capacity available on a 30" range and will accommodate a full-size commercial 18" x 26" baking sheet.

INDUCTION COOKTOP:

*4 cooktop induction zones that automatically adjust to the size of the pan

*9 heat settings on each cooktop burner

*"Power Booster" function that boils a gallon of water in less than 5 minutes!

*"Heat Accelerator" function to kickstart the cooking process on all cooking zones

*"Keep Warm" function allows two levels of even, low temperatures

ROBUST SAFETY FEATURES:

*"Knob Lock" function (knob can be electronically locked)

*Pan detection technology: Unit won't start unless a pan is on unit

*Hot surface indicator light to indicate when it's safe to touch

Install Clearance:	0" Side Cabinet
	0" Back Wall
	0" Side Wall

7.9" Diameter
1850 W

7.9" Diameter
1850 W

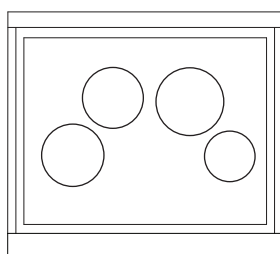

8.6" Diameter
2300 W

6.3" Diameter
1400 W



36" CLASSIC RANGE FEATURES AND SPECIFICATIONS

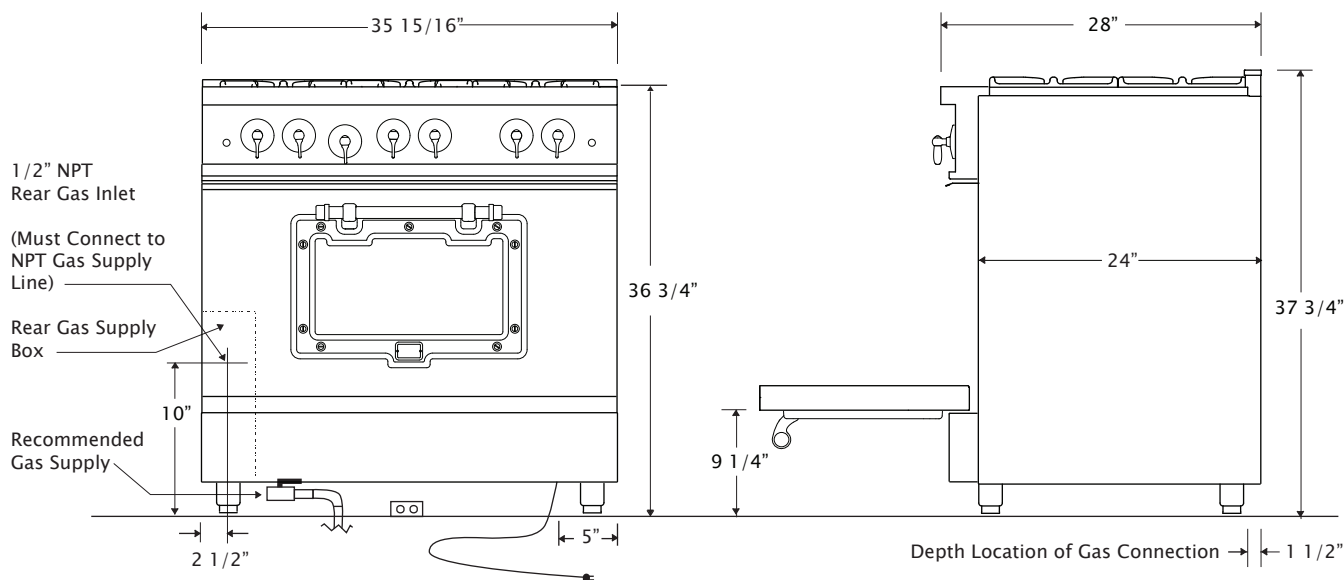

Front Burners	15,000-18,000 BTU	*Easy to clean Sealed Burner Top
Back Left Burner (Simmer)	6,000 BTU	*Automatic electronic ignition and re-ignition system
Back Center / Right Burner	10,000 BTU	*24" depth for compatibility with standard kitchen cabinetry
Infrared Broiler Rating	15,000 BTU	*Convection fan
Oven Burner Rating	30,000 BTU	*Full Extension oven rack
Electrical Requirements	120 VAC, 15 Amps,	*Heavy-duty, commercial stainless steel construction
*(Unit must be on a non-GFI, dedicated outlet)	Single Phase	*2 Years Parts and Labor Warranty
Operating Gas Pressure	NAT: 5.0" WC LP: 10.0" WC	OVEN CAPACITY:
Install Clearance:	0" Side Cabinet 0" Back Wall 6" Side Wall	The cavity design of the oven provides the most precise temperature control, which delivers even heat distribution resulting in versatile performance. It has the largest oven capacity available on a 30" range and will accommodate a full-size commercial 18" x 26" baking sheet.

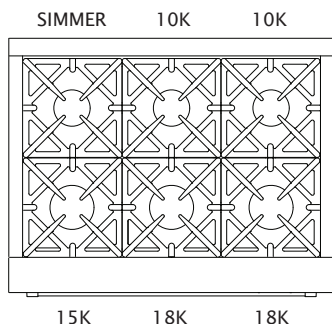

INFRARED BROILER:

Because of its popularity in the commercial market, the direct-fired ceramic infrared broiler is standard on all residential ranges. The large burner produces 1850 F of intense, searing heat close to the burner, while effecting a gentler broiling for foods placed farther away. The broiler is fully recessed into the oven's top to create maximum cooking space.

FULL MOTION GRATES:

Bring sauce to a boil while stirring on a front burner, then slide it to the rear to simmer while you saute up front! Our full motion grates allow you to easily reposition pots and pans from front to rear burners without lifting. The grates are also oversized to accommodate the largest stock pots and saute pans.

48" CLASSIC RANGE FEATURES AND SPECIFICATIONS

MODEL:
BCCS48

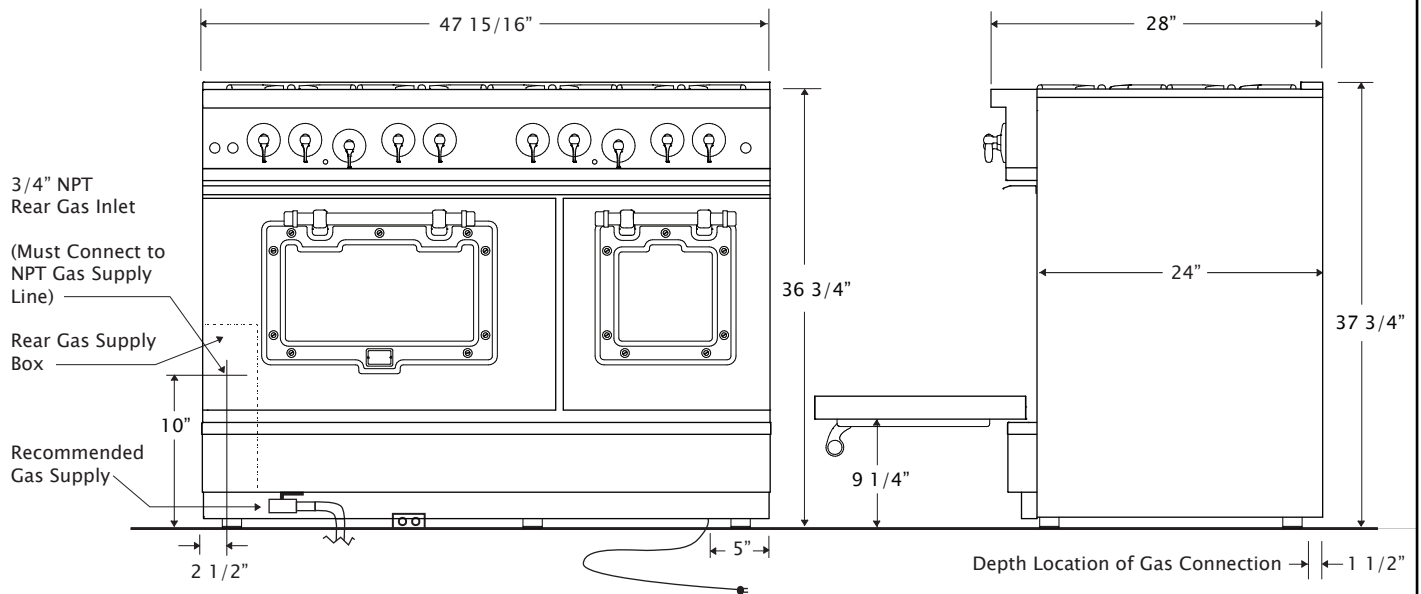

Front Burners	15,000–21,000 BTU	*Easy to clean Sealed Burner Top
Back Left Burner (Simmer)	6,000 BTU	*Automatic electronic ignition and re-ignition system
Back Burners	6,000–10,000 BTU	*24" depth for compatibility with standard kitchen cabinetry
Infrared Broiler Rating	15,000 BTU	*Convection fan
Oven Burner Rating	30,000 BTU	*Full Extension oven rack
Electrical Requirements	120 VAC, 15 Amps,	*Heavy-duty, commercial stainless steel construction
*(Unit must be on a non-GFI, dedicated outlet)	Single Phase	*2 Years Parts and Labor Warranty
Operating Gas Pressure	NAT: 5.0" WC LP: 10.0" WC	OVEN CAPACITY:
Install Clearance:	0" Side Cabinet 0" Back Wall 6" Side Wall	The cavity design of the oven provides the most precise temperature control, which delivers even heat distribution resulting in versatile performance. It has the largest oven capacity available on a 48" range and will accommodate a full-size commercial 18" x 26" baking sheet.

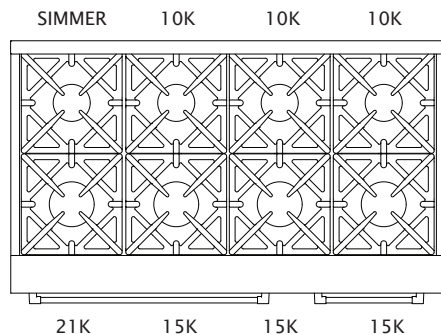

INFRARED BROILER:

Because of its popularity in the commercial market, the direct-fired ceramic infrared broiler is standard on all residential ranges. The large burner produces 1850 F of intense, searing heat close to the burner, while effecting a gentler broiling for foods placed farther away. The broiler is fully recessed into the oven's top to create maximum cooking space.

FULL MOTION GRATES:

Bring sauce to a boil while stirring on a front burner, then slide it to the rear to simmer while you saute up front! Our full motion grates allow you to easily reposition pots and pans from front to rear burners without lifting. The grates are also oversized to accommodate the largest stock pots and saute pans.

CLASSIC FEATURES AND SPECIFICATIONS

24" CLASSIC DISHWASHER

MODEL:
DW24-CLA

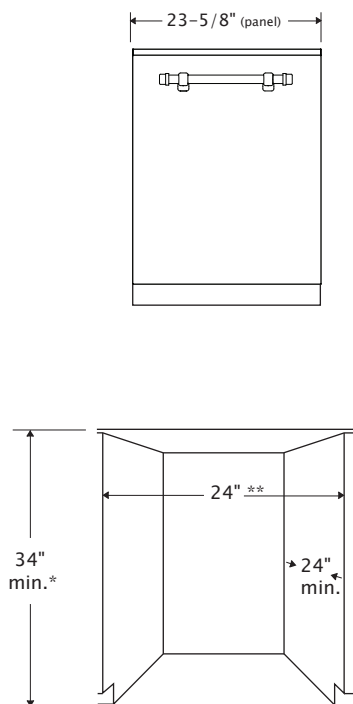

36" CLASSIC REFRIGERATOR

MODEL:
22BF-CLA

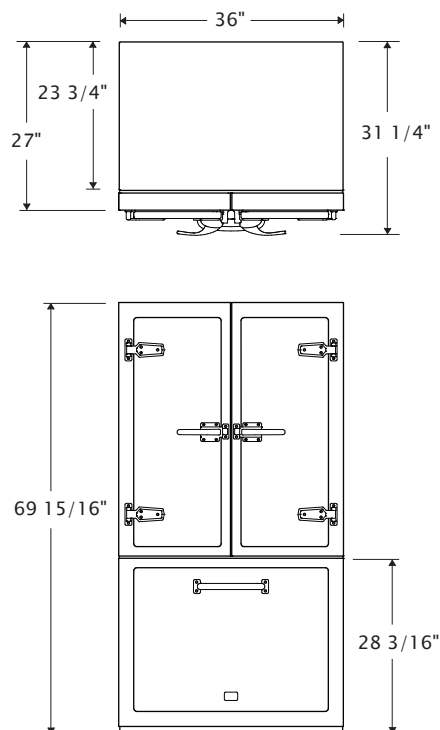

Capacity	16 Place Settings
Cycles	Auto, MixWash+, Pots and Pans+, Regular, GlassCare, Express Dry, Quick Wash
Cycle Options	Power Wash, Rapid Clean, Super Gloss, Sanitize, 1/2 Load, Time Delay
Energy Guide	225 (kWh/year) – Energy Star Rated
Warranty	2 Years Parts and Labor
Electrical	120 V, 60 Hz, AC only

FEATURES:

Stamped Metal Body, Authentic chrome, brass or satin nickel trim, Stainless Steel Interior, 45dBA Whisper Quiet Operation, 8 Wash Cycles and 6 Options, Full Size Third Rack, Energy Star Rated, Designed in Boulder, Colorado, Assembled and Shipped from Cedar Rapids, Iowa



* Measured from the lowest point on the underside of countertop.

** Minimum, measured from narrowest point of opening.



Total Capacity	19.86 cu. ft.
Refrigerator Capacity	13.3cu. ft.
Freezer Capacity	6.56 cu. ft.
Clearance: Back	1/2"
Clearance: Side	1/4"
Side Clearance for door to open 90°	4 1/2"
Adjustable Rollers	Standard
Energy Guide	566 (kWh/year) – Energy Star Rated
Warranty	2 Years Parts and Labor
Electrical	120V, 60Hz, AC only, 15 or 20 amp fused

FEATURES:

Stamped Metal Body, Authentic chrome, brass or satin nickel trim, Duo cycle cooling, Gallon Door Storage, 2 Half-Width Clear Crisper Drawers, Four Half-Width Adjustable Glass Shelves, Internal water dispenser, Ice maker, Interior LED lighting, Digital temperature management System, Slide-Out Upper Freezer Basket, Glide-Out Freezer Basket with Organizer, Energy Star Qualified



CLASSIC FEATURES AND SPECIFICATIONS

30" CLASSIC REFRIGERATOR

MODEL:
19BF-CLA

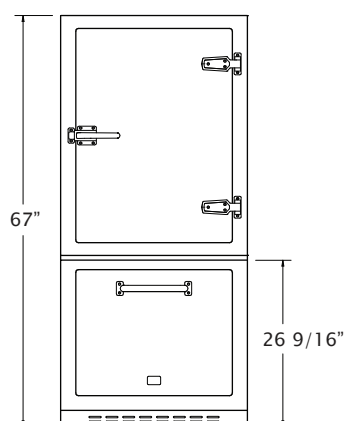
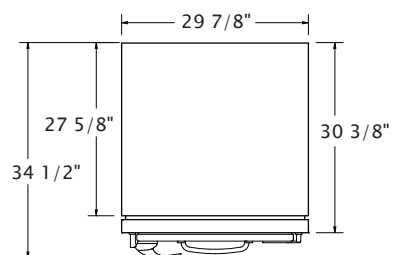

Total Capacity	18.7 cu. ft.
Refrigerator Capacity	13 cu. ft.
Freezer Capacity	5.7 cu. ft.
Clearance: Back	1/2"
Clearance: Side	1/4"
Side Clearance for door to open 90°	4 1/2"
Adjustable Rollers	Standard
Energy Guide (kWh/year)	553
Warranty	2 Years Parts and Labor Warranty
Electrical	115V, 60Hz, AC only, 15 or 20 amp fused

FEATURES:

Stamped Metal Body, Authentic Chrome, Brass, Copper or Satin Nickel Trim, Temperature Management System, Gallon Door Storage,
2 Half-Width Clear Crisper Drawers, Four Half-Width Adjustable Glass Shelves, Ice maker, Slide-Out Upper Freezer Basket,
Glide-Out Freezer Basket with Organizer, Available Left Hand Hinge

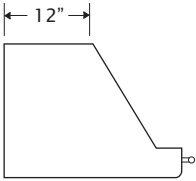
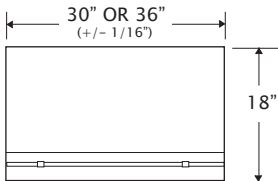
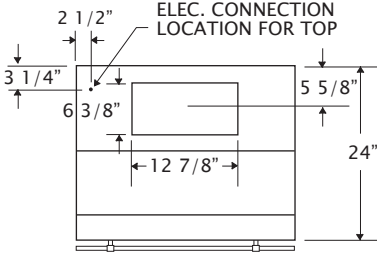
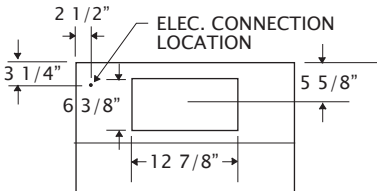
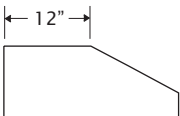
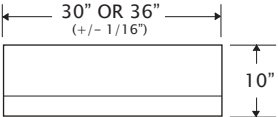
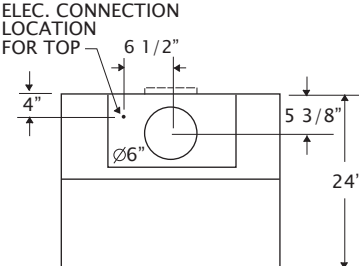
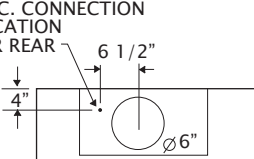
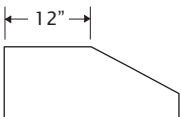
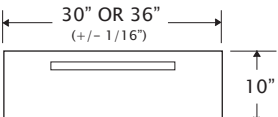
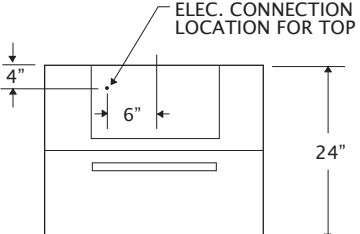
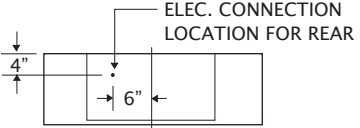

CLASSIC RANGE HOOD FEATURES AND SPECIFICATIONS

1900 Series Hood	10" Hood	10" Hood—RECIRCULATING
MODELS: (BCH3018) (BCH3618)	MODELS: (BCH3010) (BCH3610)	MODELS: (BCH3010R) (BCH3010R)
<div><p>SIDE VIEW</p><p>FRONT VIEW</p><p>TOP VIEW</p><p>BACK VIEW</p></div>	<div><p>SIDE VIEW</p><p>FRONT VIEW</p><p>TOP VIEW</p><p>BACK VIEW</p></div>	<div><p>SIDE VIEW</p><p>FRONT VIEW</p><p>TOP VIEW</p><p>BACK VIEW</p></div>