



The Life of the Kitchen.®



SGG365 Cooktop

IMPORTANT: This product may have some parts that are No Longer Available (NLA). If the part you need is no longer available, please contact Dacor for a possible solution:

DACOR CARES PROGRAM NLA Part Locator Service

Customer Contact Number:

(800) 793-0093 ex. 2813
Hours: 6:00 AM - 5:00 PM Pacific Time

Service Agent/Technician Contact Number:

(800) 793-0093 ex. 3814
Hours: 7:00 AM - 4:00 PM Pacific Time

Web Inquiries: www.dacor.com/dacorcares **Email Inquiries:** dacorcares@dacor.com

Please provide the following information:

- Your name and phone number
- Product model number
- Product serial number
- The part number(s) you need

Page #	Description
2	Top Frame Assembly
3	Chassis Assembly

Revised 10-12-2011

SGG365 - Top Frame Assembly

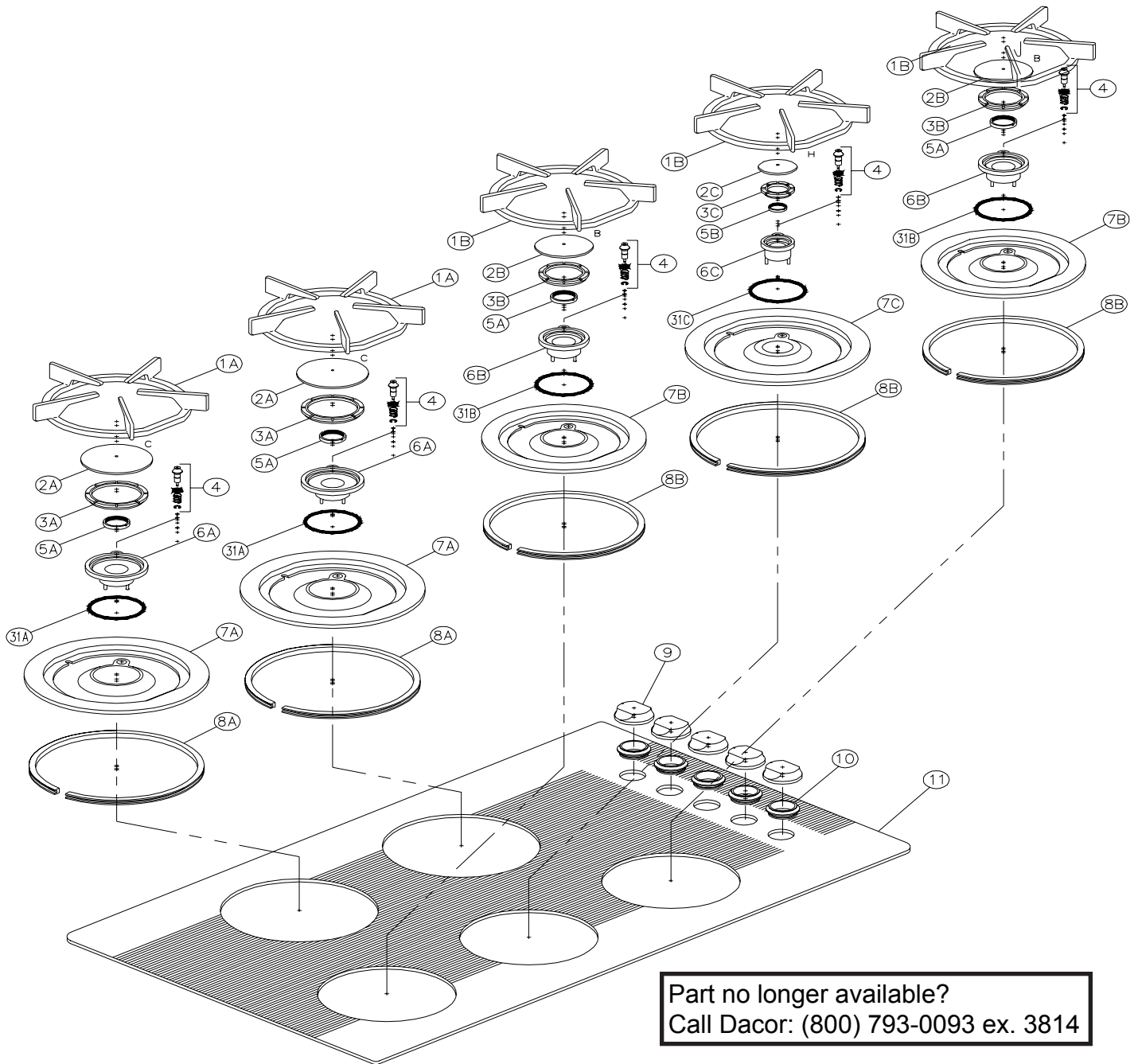

Part no longer available?
Call Dacor: (800) 793-0093 ex. 3814

REF#	PART #	DESCRIPTION	REF#	PART #	DESCRIPTION
1A	86520AP, BP, WP	LARGE BURNER GRATE	7B	26480AP, BP, WP	SPILL TRAY, MEDIUM
1B	86521AP, BP, WP	MEDIUM BURNER GRATE	8A	82398	SPILL TRAY GASKET, LARGE
2A	86523AP, BP, WP	LARGE BURNER CAP	8B	82008	SPILL TRAY GASKET, MEDIUM
2B	86524AP, BP, WP	MEDIUM BURNER CAP	9	82774A, B, W	KNOB
3A	86407	LARGE BURNER RING	10	82085A, B, W	SPILL PROTECTOR RING
3B	86408	MEDIUM BURNER RING	11	82773B, W	TOP PANEL - GLASS
4	66281	IGNITOR ASSEMBLY	*	82310A	TOP PANEL GLASS, ALMOND
5	86405	BRASS NUT			
6A	86396	BURNER HEAD, LARGE			
6B	86398	BURNER HEAD, MEDIUM			
7A	26481AP, BP, WP	SPILL TRAY LARGE			
	**86525AP, BP, WP	SMALL BURNER CAP			

**see service manual to order the correct valve

SGG365 - Chassis Assembly

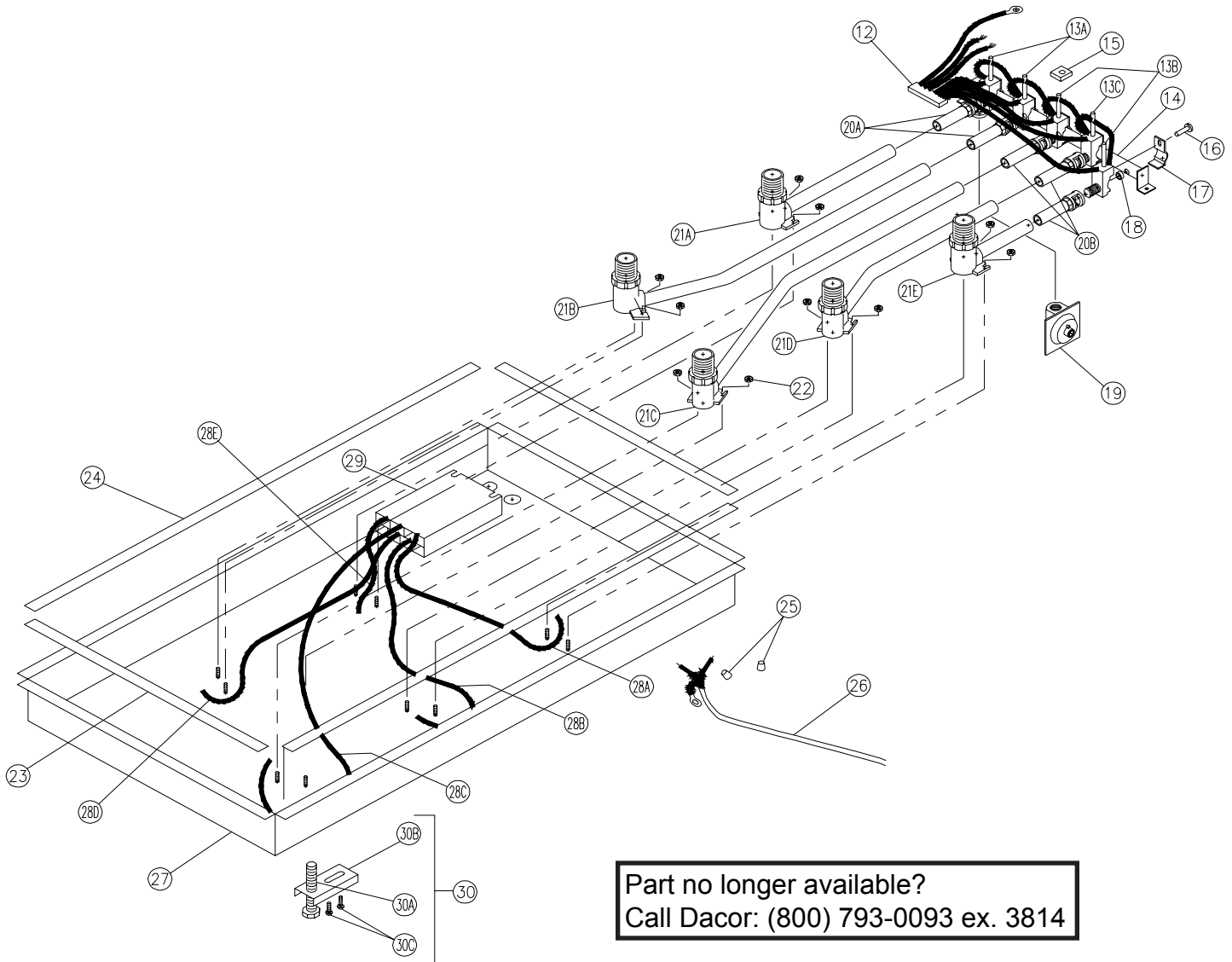

Part no longer available?
Call Dacor: (800) 793-0093 ex. 3814

REF#	PART #	DESCRIPTION
12	82770	WIRING HARNESS, MODULE TO SWITCHES
*	82780	WIRING HARNESS, MODULE TO SWITCHES
13A**	86449	BURNER VALVE, LARGE NG
*	86452	BURNER VALVE, LARGE LP
*	86443	BURNER VALVE, LARGE NG
*	86446	BURNER VALVE, LARGE LP
13B**	86450	BURNER VALVE, MEDIUM NG
*	86453	BURNER VALVE, MEDIUM LP
*	86444	BURNER VALVE, MEDIUM NG
*	86447	BURNER VALVE, MEDIUM, LP
14	86370	MANIFOLD
15	86046	MICROSWITCH, SPARK
*	86420	MICROSWITCH, SPARK
16	86386	SCREW, VALVE MOUNTING
17	86384	MOUNTING BRACKET
18	86385	WASHER
19	82540	REGULATOR
20A	86373	AIR SHUTTER, LARGE BURNER

REF#	PART #	DESCRIPTION
20B	86372	AIR SHUTTER, MEDIUM BURNER
21A	82397	BURNER TUBE - RF, RR
21B	82394	BURNER TUBE, LF
21C	82392	BURNER TUBE, LR
21D	82391	BURNER TUBE, CF
21E	82390	BURNER TUBE RF
22	83048	8-32 KEPS NUT
23	83224	FOAM TAPE, DOUBLE SIDED, 18"
24	83240	FOAM TAPE, SINGLE SIDED, 26-1/2 INCHES LONG
25	83126	WIRE NUT
26	12138	POWER CORD ASSEMBLY
27	13174	CHASSIS ASSEMBLY
28A	86441	WIRE, MODULE TO RF IGNITOR
28B	86441	WIRE, MODULE TO LF IGNITOR
28C	86440	WIRE, MODULE TO LR IGNITOR
28D	86439	WIRE, MODULE TO RR IGNITOR
29	86527	SPARK MODULE
30	12277	HOLD DOWN BRACKET

**see service manual to order the correct valve