

INSTRUCTION MANUAL

Effective October 1, 2001: All Montague heavy duty ranges and broilers will be built with orifices and regulators set to operate on 6" W.C. manifold pressure

You must specify the manifold pressure and gas type listed on the model identification plate to order replacement burner valves, orifices, or pressure regulators.

MONTAGUE LEGEND

Gas Fired Heavy Duty Counter Ranges

**Models:
C12, C18, C24 & C36**

**These instructions should be read thoroughly before attempting installation.
Set up and installation should be performed by qualified installation personnel.**

Keep area around appliances free and clear from combustibles.

**PLEASE RETAIN THIS MANUAL
FOR FUTURE REFERENCE.**



SERVICE

ORIFICE SIZE CHART DRILL SIZE

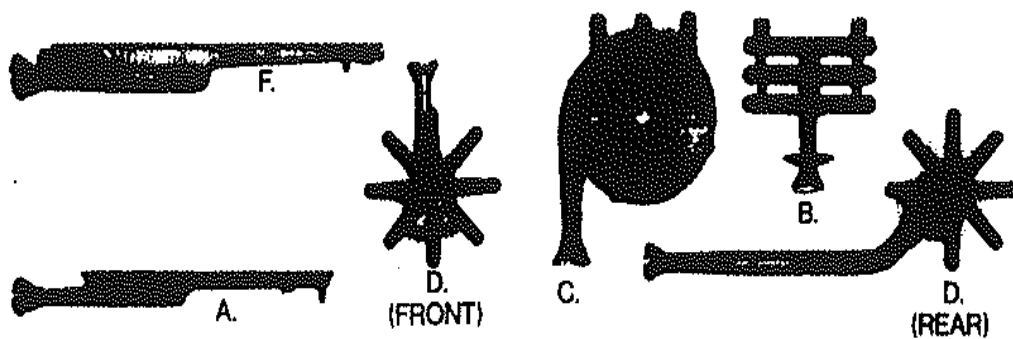

A. FRY TOP B. 12" HOT TOP C. 18" HOT TOP
D. OPEN TOP F. EVEN HEAT HOT TOP & FRY TOP

Type of Burn- er	A	B	C	D Open Top 20,000	D Open Top 30,000	D 1/2 Hot Top		F
						Front	Rear	
Natural Gas 4.0" W.C.	50	46	35	45	37	45	50	45
Natural Gas 6.0" W.C.				48	42	45	52	
Propane Gas 10.0" WC	56	55	50	55		55	56	55

MONTAGUE HEAVY DUTY GAS RANGE
OPEN TOP SECTION - 12" AND 18" WIDE
1/2 OPEN TOP 1/2 HOT TOP - 12" WIDE

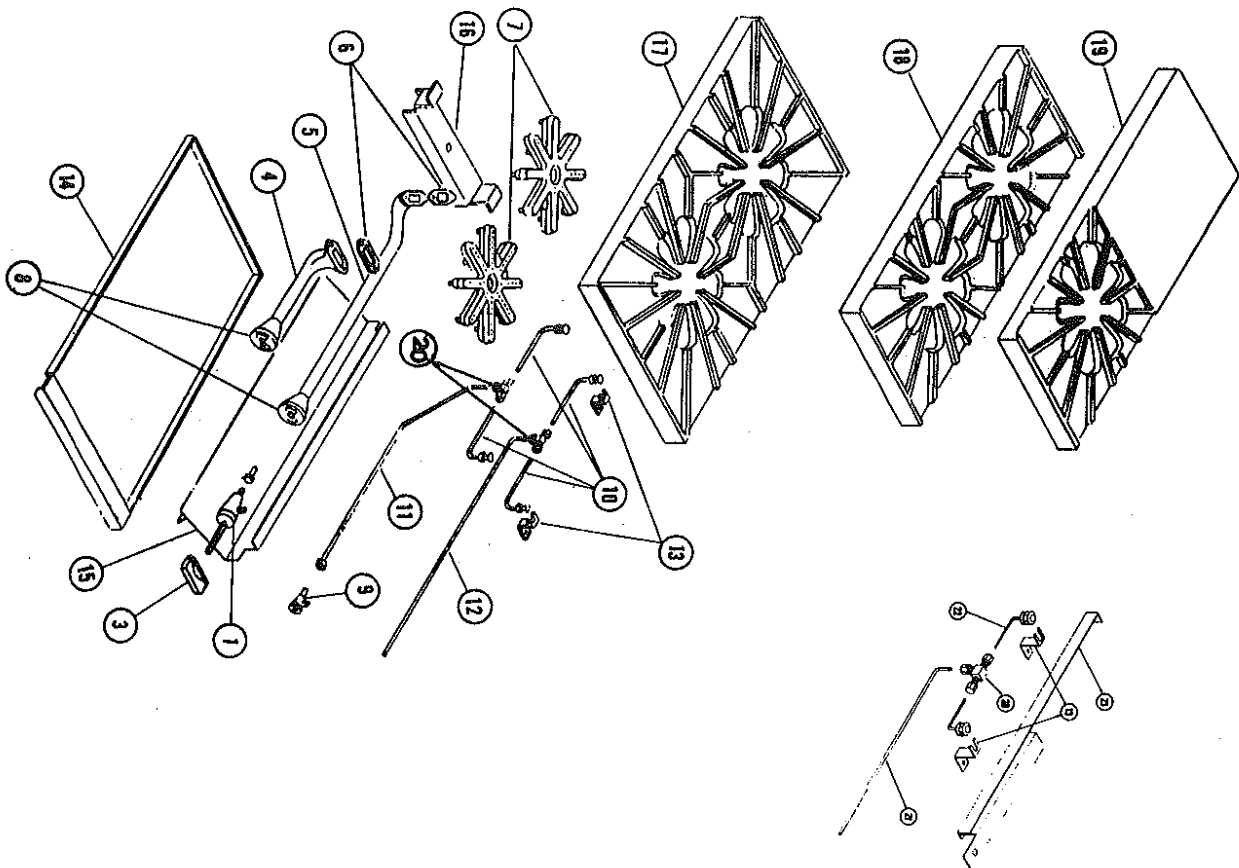

ITEM	PART NO.	DESCRIPTION
1	04330-3	Valve, Top Burner (Nat) Δ Except 1/2 Hot Top
1	01003-0	Valve, Top Burner (LP) Δ Except 1/2 Hot Top
1	02405-8	Valve, Top Burner (Nat) Δ 1/2 Hot Top Only
1	01002-2	Valve, Top Burner (LP) Δ 1/2 Hot Top Only
3	02002-8	Handle, Valve w/Set Screw
4	03348-0	Venturi, Front Burner
4, 6, 7, 8	03347-2	Burner, Front - Complete
5	03350-2	Venturi, Rear Burner (Left swing shown) Δ
5, 6, 7, 8	03349-9	Burner, Rear Left - Complete
5A, 6, 7, 8	03351-0	Burner, Rear Right - Complete (not shown)
6	02115-6	Gasket
7	03346-4	Burner Head Only
8	02038-9	Air Mixer
9	01055-3	Pilot Valve
10	03583-1	Lighter, Pilot
10, 11, 20	03431-2	Pilot Kit - 12" Section (less Valve)
10, 12, 20	03430-4	Pilot Kit - 18" Section (less Valve)
20, 21, 22	07142-0	Pilot Kit - 12" -59 Section (less Valve)
13	01518-0	Pilot Bracket
14	03379-0	Drip Tray - 36" Unit Δ
14	03378-2	Drip Tray - 24" Unit Δ
14	03377-4	Drip Tray - 18" & 12" Unit Δ
15	03380-4	Drip Tray Guide
16	03498-3	Support, Open Burner 36" Unit Δ
16	03530-0	Support, Open Burner 24" Unit Δ
16	03531-9	Support, Open Burner 18" Unit Δ
16	03532-7	Support, Open Burner 12" Unit Δ
17	03480-0	12" Open Top
18	03580-7	12" Open Top
19	03482-7	12" Combination -59 Top (1/2 Hot Top)
22	06232-4	Lighter, Pilot
23	03556-4	Bracket, Pilot Mfg (-59 Top)

- Δ Specify Type of Gas & Manifold Pressure
 Δ Specify Left or Right Swing
 Δ Specify Width

FRY TOP SECTION THERMOSTAT CONTROLLED OR 42" DEEP RANGE

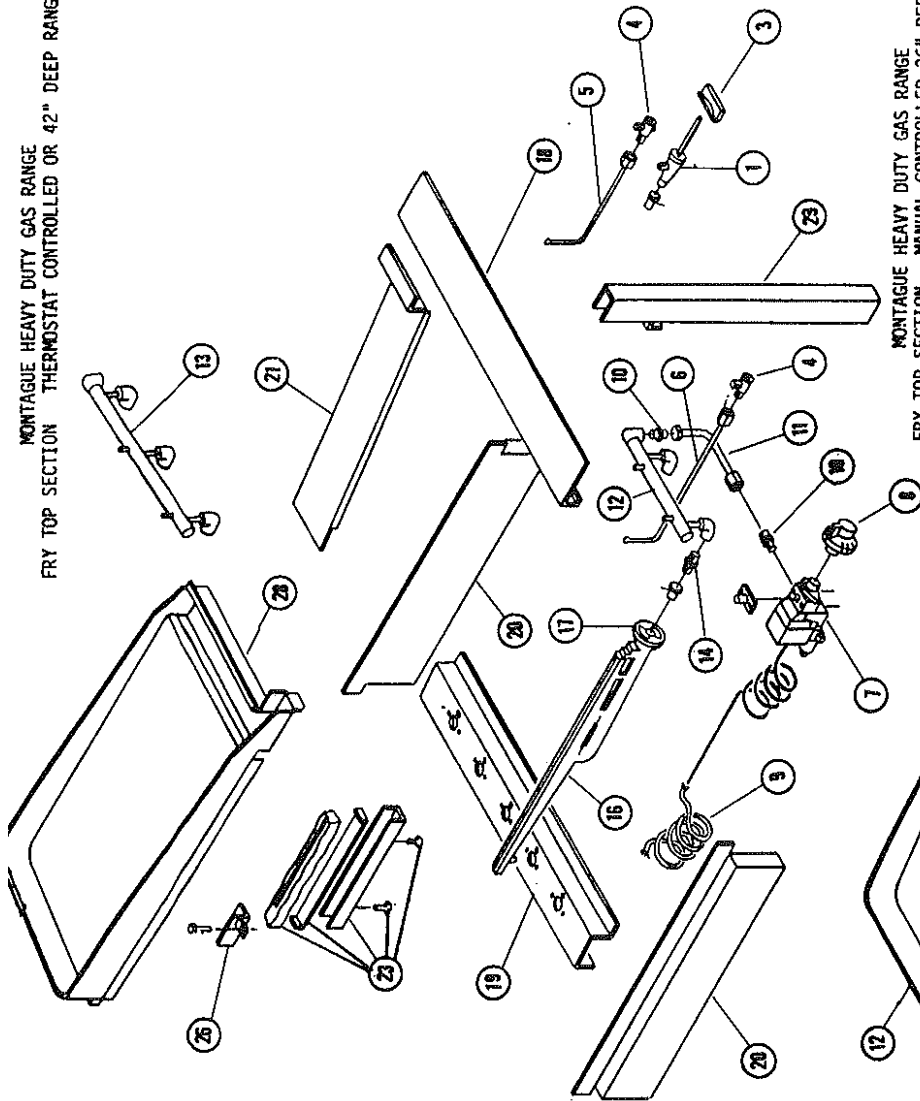

FRY TOP SECTION - MANUAL CONTROLLED 36" DEEP RANGE

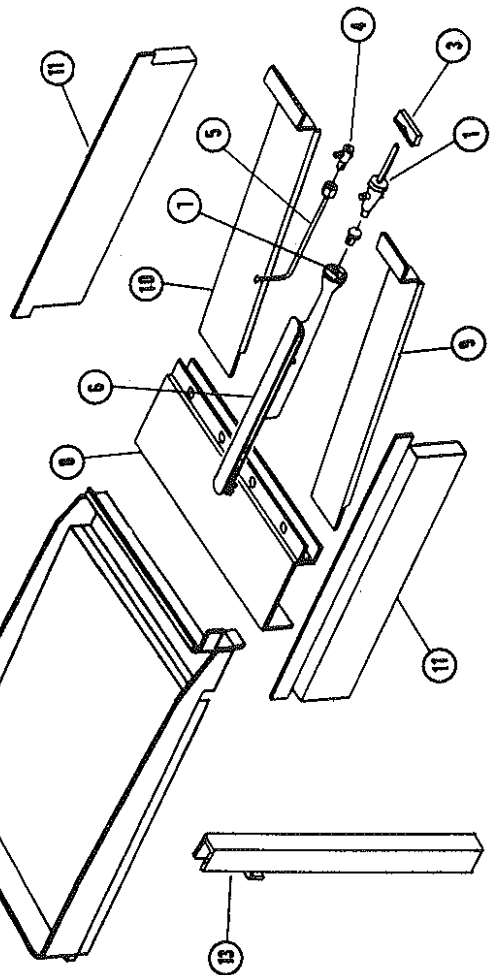

PLEASE ORDER BY PART NO. AND DESCRIPTION

ITEM	PART NO.	DESCRIPTION
1	04330-3	Valve, Top Burner - Nat
2	01003-0	Valve, Top Burner - LP
3	02002-8	Handle, Valve w/set screw
4	01055-3	Valve, Pilot
5	03416-9	Pilot Lighter (without thermostat)
6	03418-5	Pilot Lighter (with thermostat)
7	03367-7	Thermometer, Giddle - BWA w/Dial
8	01022-7	Dial, Thermostat
9	01125-0	Insulation Sleeve for Capillary
10	01271-8	Fitting 1/4" NPT x 7/16" Tubing
11	01031-7	Aluminum Tubing 7/16" CC
12	01104-5	Manifold - 3 Burner
13	02407-4	Fitting Hex w/Orifice - Nat
14	01059-6	Fitting Hex w/Orifice - LP
15	03342-6	Burner, Complete
16	02037-0	Air Mixer, Burner
17	02037-0	Air Mixer, Burner
18	03302-5	Support - Front, Air Baffle - 36"
19	03303-3	Support - Front, Air Baffle - 24"
20	03304-1	Support - Front, Air Baffle - 18"
21	07127-7	Support - Front, Air Baffle - 12"
22	07130-7	Support, Burner - 36"
23	07138-5	Support, Burner - 24"
24	07129-3	Support, Burner - 18"
25	01550-2	Support, Burner - 12"
26	01551-5	Baffle, Heat Assy. 3-1/8" Small
27	01552-8	Baffle - Air Assy. 5-1/8" Medium
28	03386-3	Thermal Bulb Holder, Complete
29	06004-6	Adjusting Bracket w/Bolt, Left
30	06003-4	Adjusting Bracket w/Bolt, Right
31	01368-5	Fry Top
32	02150-4	Container, Grease - Painted
33	02150-4	Container, Grease - Chromed

- Specify Finish
- Specify Gas and Manifold Pressure
- Specify Width & Thickness
- Specify Width











PLEASE ORDER BY PART NO. AND DESCRIPTION



ITEM	PART #	DESCRIPTION
1	02405-8	Valve, Top Burner - Nat
2	01002-2	Valve, Top Burner - LP
3	02002-8	Handle, Valve w/Set Screw
4	01055-3	Valve, Pilot
5	03416-9	Pilot Lighter
6	03361-8	Burner-Complete
7	02038-9	Air Mixer
8	03559-9	Support, Burner - 36" Unit
9	03541-6	Support, Burner - 24" Unit
10	07126-9	Support, Burner - 18" Unit
11	03006-1	Support, Burner - 12" Unit
12	03533-5	Baffle - Air Assy. 5-1/8" Small
13	03540-8	Baffle - Air Assy. 5-1/8" Medium
14	03560-2	Baffle - Heat Assy.
15	03388-5	Frytop
16	02150-4	Container, Grease - Painted
17	02150-4	Container, Grease - Chromed

- Specify Finish
- Specify Gas and Manifold Pressure
- Specify Width and Thickness
- Specify Width

MONTAGUE HEAVY DUTY GAS RANGE
HOT TOP SECTION 12" WIDE FRONT FIRED



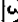



PLEASE ORDER BY PART NO. AND DESCRIPTION



ITEM	PART #	DESCRIPTION
1	02406-6	Valve, Top Burner - Nat 
1	01003-0	Valve, Top Burner - LP 
3	02002-8	Handle, Valve W/Set Screws 
4	01055-3	Valve, Pilot
5	03421-5	Pilot Lighter
6	04299-4	Burner Support W/Insulation - 36" 
6	04284-6	Burner Support W/Insulation - 24" 
6	04283-8	Burner Support W/Insulation - 12" 
7	-----	Insulation Pad 
9	03353-7	Burner, 12" Hot Top 
10	02038-9	Air Mixer
11	01635-7	Baffle, Burners - Cast Iron
12	-----	Manifold Shield W/Stops 
13	03560-2	Insulated Side Shield 
14	01738-8	Hot Top - 12" Section

-  Specify Gas & Manifold Pressure
-  Specify Width

MONTAGUE HEAVY DUTY GAS RANGE
HOT TOP SECTION - EVEN HEAT 12" AND 18" WIDE

PLEASE ORDER BY PART NO. AND DESCRIPTION

ITEM	PART NO.	DESCRIPTION
1	04330-3	Valve, Top Burner - Nat 
1	01003-0	Valve, Top Burner - LP 
3	02002-8	Handle, Valve W/Set Screw 
4	01055-3	Valve, Pilot
5	03416-9	Pilot Lighter
6	03362-6	Burner, Even Heat Hot Top - Complete
7	02037-0	Air Mixer
8	10628-3	Support, Burner - 36"
8	04468-7	Support, Burner - 24"
8	10629-1	Support, Burner - 18"
8	07133-1	Support, Burner - 12"
9	03560-2	Baffle - Heat Assy. 
10	03533-5	Baffle - Air Assy. 3-1/8" wide 
10	03538-6	Baffle - Air Assy. 9-1/4" wide 
11	01738-8	Hot Top, 12" Section
12	01741-8	Hot Top, 18" Section

-  Specify Gas & Manifold Pressure
-  Specify Width

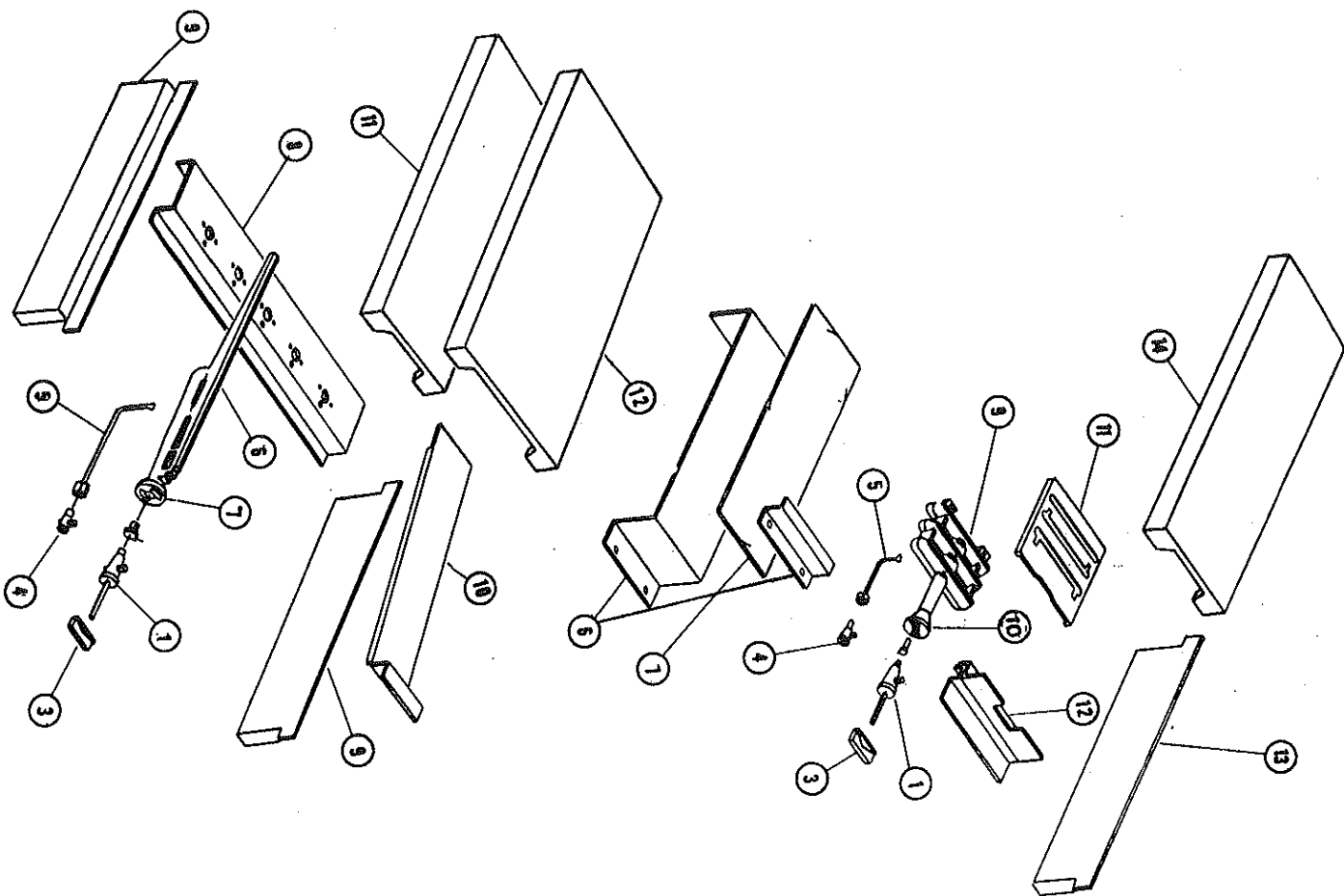

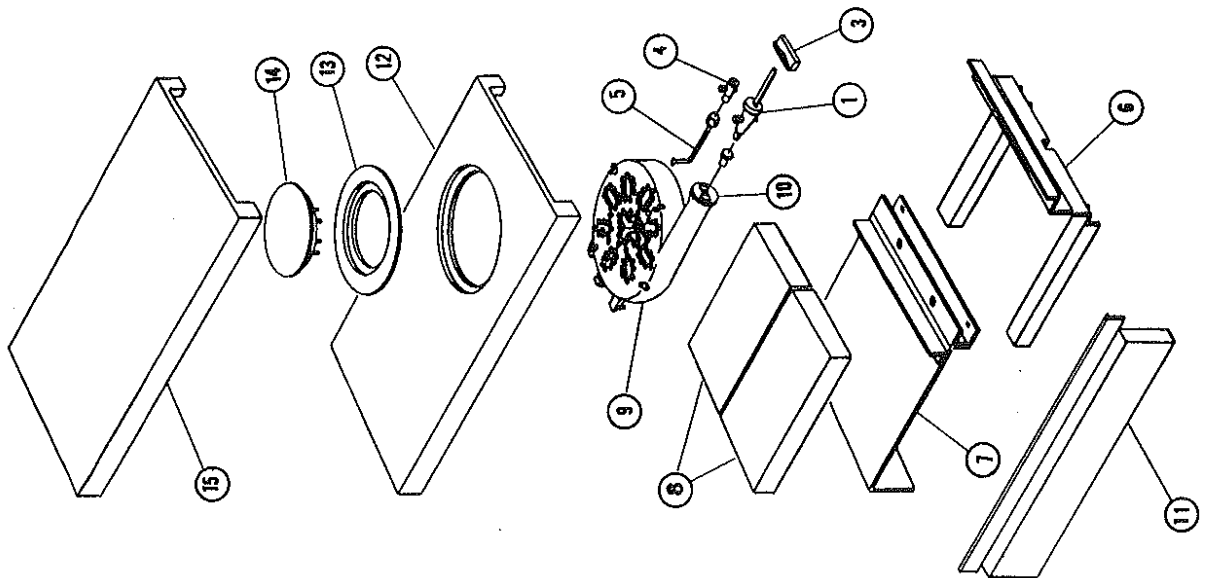

MONTAGUE HEAVY DUTY GAS RANGE
HOT TOP SECTION 18" WIDE FRONT FIRED

PLEASE ORDER BY PART NO. AND DESCRIPTION

ITEM	PART NO.	DESCRIPTION
1	02408-2	Valve, Top Burner - Nat.
1	02405-8	Valve, Top Burner - LP
3	02002-8	Handle, Valve w/Set Screw
4	01055-3	Valve, Pilot
5	03419-3	Pilot Lighter
6	04412-1	Baffle-Air Assy - 36" Unit Δ
6	04414-8	Baffle-Air Assy - 18" Unit Δ
7	04281-1	Burner & Brick Support - 36" Unit
7	04298-6	Burner & Brick Support - 18" Unit
8	01764-7	Brick (1-1/4 x 8 x 13)
9	03356-1	Burner, 18" Hot Top - Complete (Right Swing) Δ
9A	03355-3	Burner, 18" Hot Top - Complete (Left Swing) Not Shown Δ
10	02037-0	Air Mixer
11	03560-2	Insulated Side Shield
12	01743-4	Hot Top - 18" W/Ring & Cover
13	01745-0	Ring
14	01747-7	Cover
15	01741-8	Hot Top - 18" - Solid

Δ Specify Gas & Manifold Pressure

Δ Specify Swing

Δ Specify Width