

820063 IM15/S-LP & ICBIM15/S-LP Nat Gas Conversion Kit

⚠ WARNING

THIS CONVERSION KIT MUST BE INSTALLED BY A QUALIFIED SERVICE TECHNICIAN IN ACCORDANCE WITH MANUFACTURERS INSTRUCTIONS AND ALL APPLICABLE CODES AND REQUIREMENTS OF THE AUTHORITY HAVING JURISDICTION. IF THE INFORMATION IN THESE INSTRUCTIONS IS NOT FOLLOWED EXACTLY, A FIRE, EXPLOSION OR PRODUCTION OF CARBON MONOXIDE MAY RESULT; CAUSING PROPERTY DAMAGE, PERSONAL INJURY OR LOSS OF LIFE. THE QUALIFIED SERVICE TECHNICIAN IS RESPONSIBLE FOR THE PROPER INSTALLATION OF THIS KIT. THE INSTALLATION IS NOT PROPER AND COMPLETE UNTIL THE OPERATION OF THE CONVERTED APPLIANCE IS CHECKED AS SPECIFIED IN THE MANUFACTURER'S INSTRUCTIONS SUPPLIED WITH THIS KIT.

CONTAINS:

QTY	DESCRIPTION
1	Orifice, Wok Stamped #195
1	Rating Label - IM15/S
1	Rating Label - ICBIM15/S
1	Instructions

NOTES: This conversion kit is intended for converting the Wolf Multifunction Cooktop models listed below from liquid propane to natural gas, for altitudes up to 10,250 feet (3.1 km). Contact the factory if above this altitude.

Models	IM15/S-LP	ICBIM15/S-LP
--------	-----------	--------------

NOTE: Only valid for the above models starting with Serial Number 16,000,000.

TOOLS NEEDED: Phillips Head Screwdriver, 10mm Open Ended Wrench and a 7mm Wrench

⚠ CAUTION

Shut off gas supply to the appliance prior to disconnecting the electrical power.

INSTALLATION PROCEDURE:

1. First, remove the burner grate, burner head and the control knob from the unit and set aside (See Figure 1).
2. Next, extract three (3) Phillips head screws, one (1) from front and two (2) from the rear of the unit.
3. Now, remove stainless steel pan and set aside.
4. Using a 10mm wrench, remove the Orifice, Wok LP (stamped 146) and it replace with the supplied Orifice, Wok Nat (stamped 195). Adjust the Venturi Tube to the first marked line by loosening the set screw on the jet holder and sliding the tube out. Retighten the set screw (See Figure 2 on page 2).

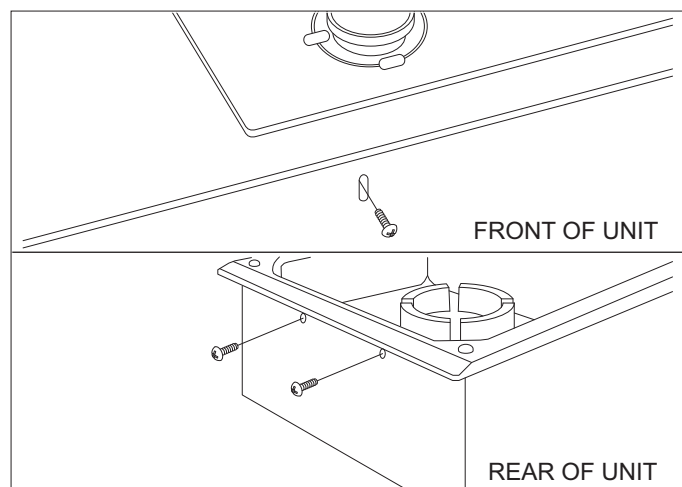

Figure 1. Extract Screws from Front & Rear of Unit.

820063

IM15/S-LP & ICBIM15/S-LP Nat Gas Conversion Kit

- Once leak test has been completed (see Leak Test instructions below), replace stainless steel pan and re-insert screws.

Gas Regulator For IM15/S Only:

Convertible Gas Regulator: The gas regulator is located under the burner box. Using a 23mm, 7/8" socket or adjustable wrench, remove the regulator access cap. On the inside of the cap, remove the plastic insert (See Figure 3) and invert it so that the disk end is out and replace it in the cap. Replace the cap into the regulator.

NOTE: This conversion adjusts for proper manifold pressure for Natural gas from LP gas.

For IM15/S Manifold Pressure: With conversion complete, manifold pressure should be 5" of water column. The supply pressure should be from an approved Nat source at min. and max. pressure of 7" and 14" of water column respectively.

For ICBIM15/S Manifold Pressure: With conversion complete, manifold pressure should be 20 mbar. The supply pressure should be from an approved Nat source at min. and max. pressure of 17 mbar and 25 mbar respectively.

Flame Characteristics: The flame produced by the burner should be a quiet, blue flame, exhibiting no lifting or blowing (See Figure 3). No modifications should be needed to the flame, but if the burner is not exhibiting a proper flame, the CO level should be monitored at all times during modification using an electronic CO analyzer, or equivalent. To modify flame characteristics on an open top outer burner, loosing the venturi set screw and move the venturi in or out until the proper flame is obtained.

Ignition System: If unit is operating properly after conversion, burner should ignite within 4 seconds of gas flowing out of burner ports. If the flame is extinguished, the unit should automatically re-ignite within 4 seconds. When burner is operating correctly, with a proper, hard flame, the unit should not be sparking.

Leak Testing: With orifice converted, apply soapy water to all joints and fittings. Turn on the burner and check thoroughly for leaks. Then turn off all the burners and re-check for leaks.

Labels: Once installation is completed, and all appropriate tests have been satisfied, fill out all applicable information and affix the new Rating Label as close as possible to the existing rating plate.

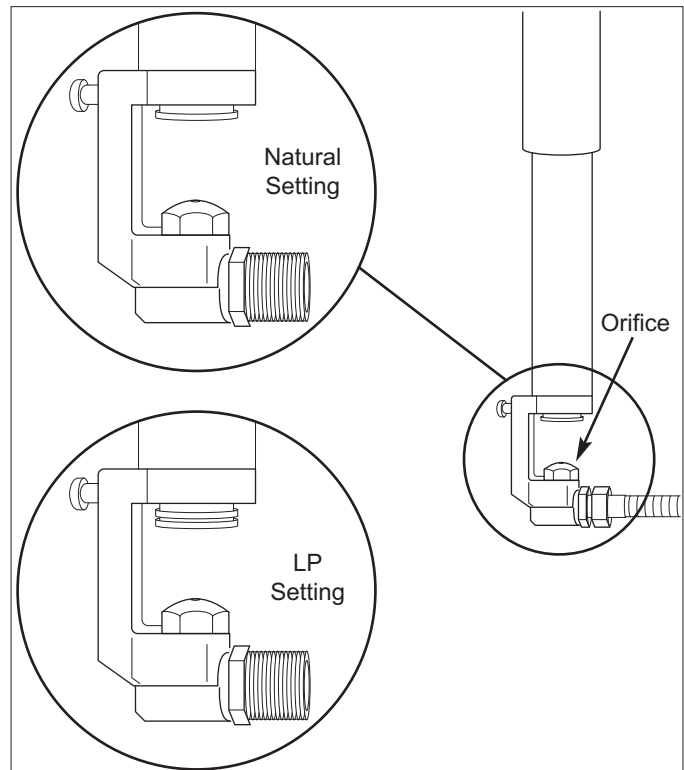

Figure 2. Orifice Location

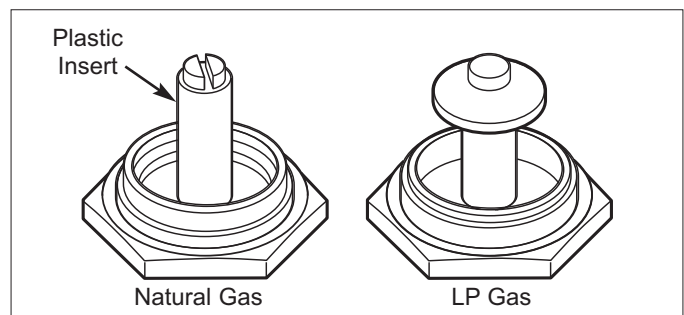

Figure 3. Gas Regulator

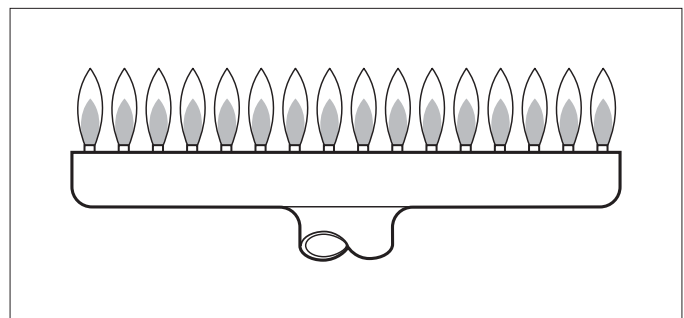

Figure 4. Flame Appearance.