

# INSTRUCTION MANUAL

## Gas Cheesemelter

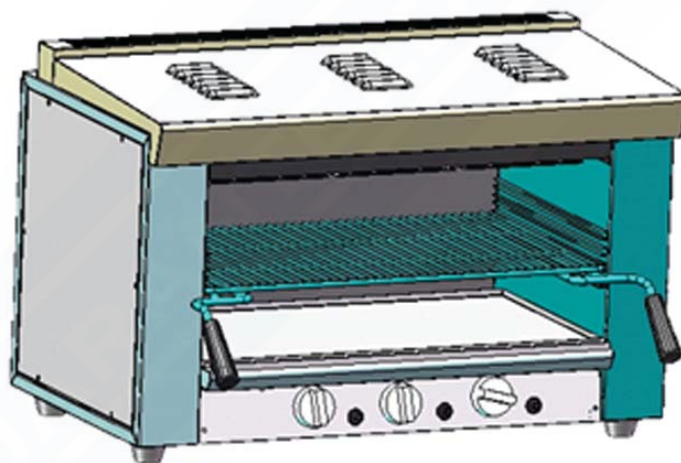

# Parts Diagram for the Gas Cheesemelter

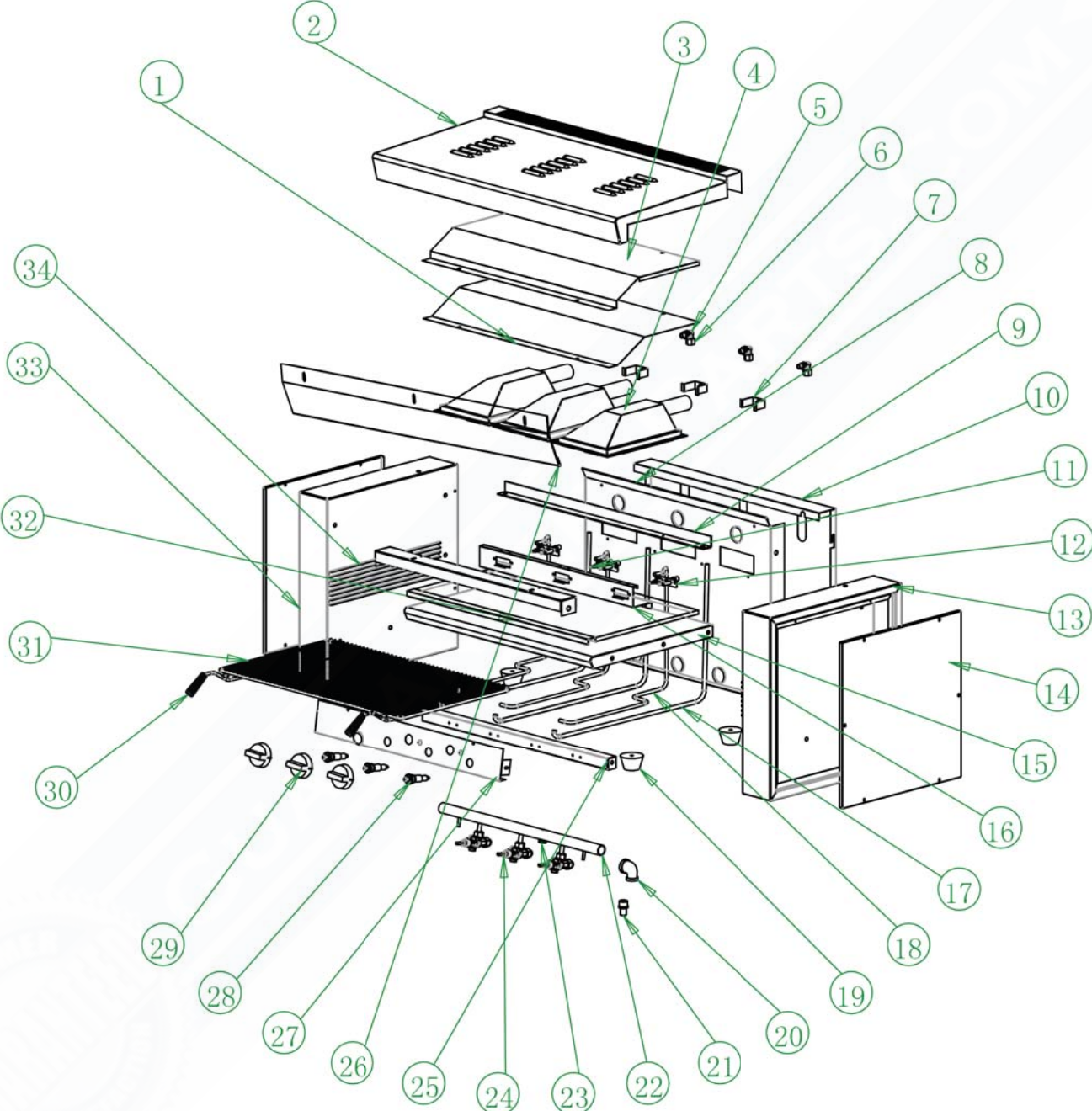

Drawing Number	Part Number	Description	Quantity
1		Top plate of inner chamber	1
2		Top plate	1
3		Upper plate to press insulation	1
4		Infrared Burner	3
5		Orifice Base	3
6		Nut to connect aluminum pipe	3
7		Orifice bracket	3
8		Rear plate of inner chamber	1
9		Rear beam	1
10		Rear plate	1
11	CHM-11	Thermocouple	3
12		Pilot bracket	3
13		Right side assembly	1
14		Side plate	2
15		Bottom plate of inner chamber	1
16		Probe base plate	1
17		Burner's gas pipe	3
18		Pilot's gas pipe	3
19		Rubber foot	4
20		1/2" angle connector	1
21		1/2" gas bend connector	1
22		Gas distribution pipe	1
23		Test orifice	1
24		Gas safety valve	1
25		Bottom beam	1
26		Baffle plate	1
27		Front panel plate	1
28		Ignition switch	3
29		Control knob	3
30		Bakelite handle	2
31		Broiler rack	1
32	SALCH-30	Crumb tray	1
33		Left side assembly	1
34		Rack guide	8