

FFSGS6239-48

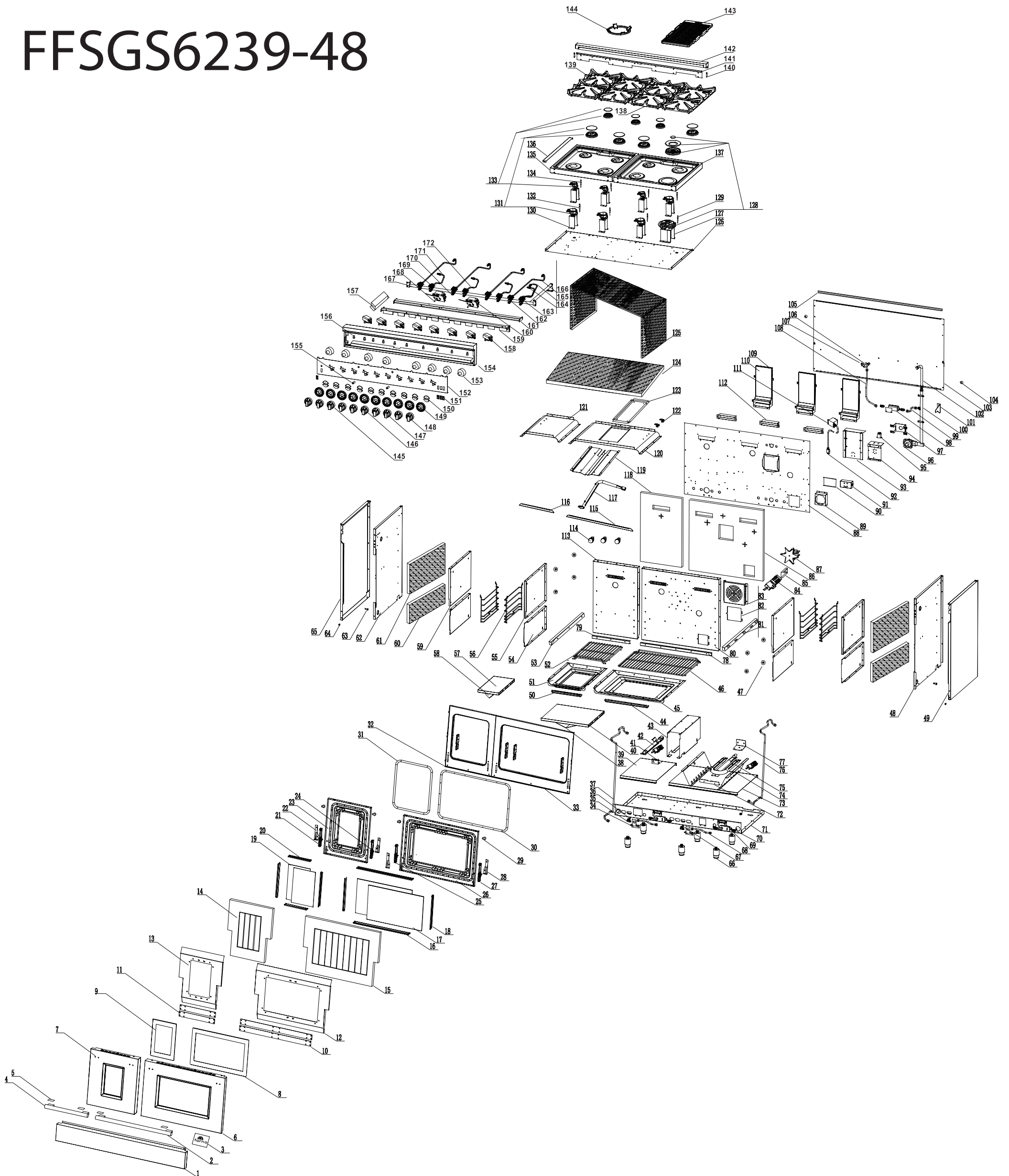

FFSGS6239-48			
No.	Material Name	Material Code	Quantity
1	48" drawer panel	G48X01-120102-Z	1
2	handle	G30R04-101900	1
3	metal logo	G36R03-020010	1
4	18" handle	G18R04-101900	1
5	handle rubber mat	G36R03-100700	4
6	door stainless steel cover	G48R03-100401	1
7	18" door stainless steel cover	G18R03-100401	1
8	door outer glass	G30R03-101100	1
9	18" door outer glass	G18R03-101100	1
10	door outer glass black pressing plate	G30R03-101400-02	2
11	18" door outer glass black pressing plate	G18R03-101400-02	2
12	door insulation plate	G30X03-101401	1
13	18" door insulation plate	G18X03-101401	1
14	18" door glass wool	G18X03-103500	1
15	door glass wool	G30X03-103500	1
16	door inner glass top/down stip	G30X03-101501	2
17	inner door glass	G30R03-100500	2
18	door inner glass R/L strip	G36X03-101601	4
19	18" innder door glass	G18R03-100500	2
20	18" door inner glass top/down stip	G18X03-101501	2
21	18" door hinge R	G18R03-110010	1
22	door strengthen part R	G36X03-101000	2
23	18" door blue enameled component	G18R03-100602-Z	1
24	18" door hinge L	G18R03-110000	1
25	door hinge R	G30R03-110010	1
26	door blue enameled component	G30R03-100602-Z	1
27	door hinge L	G30R03-110000	1
28	door strengthen part L	G36X03-101001	2
29	door round rubber mat	EM265A-109000	4
30	door seal bar	G48R03-071200	1
31	18" door seal bar	G18R03-071200	1
32	18" front panel	G18R03-070100-Z	1
33	front panel	G48R03-070100-Z	1
34	oven burner nozzle mount support	G36X03-090700	2
35	oven burner nozzle mount	G36X03-021101	2
36	48" grill burner nozzle NG 1.7	G48X04-021203	1
37	5/8" corrugated pipe 1500mm	G20C01-215305	1

38	oven burner reflect board	G30X03-080900	1
39	18" drawer insulation plate	G18X03-072100	1
40	down blue enameled tray	G30R07-210102	1
41	grill burner back fixed support	G18X03-080700	1
42	48" grill burner	G18X03-080100	1
43	48" oven U type burner downside plate	G48X03-070400	1
44	cavity down strengthen part	G30X03-070000	1
45	cavity down blue enameled plate	G30X03-070704-Z	1
46	baking rack	G30R05-071900	2
47	side rack protect cover	G36X03-073900	16
48	right outside plate inside component	G36X03-071104-Z	1
49	right outside plate X01 series	G36X01-071001	1
50	18" down strengthen part	G18X03-070000	1
51	18" cavity down blue enameled plate	G18X03-070704-Z	1
52	18" baking rack	G18R05-071900	2
53	slide rail L X01 series	G36X01-120700	4
54	cavity downside plate	G36X03-070400	2
55	48" cavity top right side blue enameled plate	G36X04-070508	2
56	side rack X01 series	G36X01-073800	4
57	18" down blue enameled tray	G18R07-210102	1
58	18" oven burner reflect board	G18X03-080900	1
59	48" cavity top left side blue enameled plate	G36X04-070509	2
60	cavity down left glass wool	G36X03-073000	5
61	cavity top left glass wool	G36X03-073300	5
62	left outside plate inside component	G36X03-071105-Z	1
63	screw for anti-tip step	G36X03-111000	1
64	drawer panel fixed screw	G36X03-130100	2
65	left outside plate X01 series	G36X01-071000	1
66	2.5" oven legs	G36R05-071500	6
67	oven burner nozzle NG 2.20	G18X03-021206	1
68	5/8" corrugated pipe 160mm	G20C01-215306	2
69	safety valve small support	G36X03-076500	2
70	safety valve gas inlet	G36X03-210500	6
71	48" bottom plate	G48R05-071800	1
72	U type burner downside support	G36X03-080600	1
73	drawer insulation plate	G30X03-072100	1
74	U type burner baffle plate	G36X03-200800	2
75	oven U type burner	G36X03-080100	1
76	5/8" corrugated pipe 900mm	G20C01-215304	1
77	U type burner back support	G36X03-080700	1

78	cavity strengthen part	G30X03-070200	1
79	18" cavity strengthen part	G18X03-070200	1
80	cavity back plate	G30X03-070303	1
81	right slid rail X01 series	G36X01-120701	4
82	small baffle plate	E20F01-072000	1
83	fan motor cover	G36X03-091701	1
84	oven cavity spark plug	G36X03-170300-1	3
85	grill burner spark plug support	G36X03-090600	1
86	cavity back plate glass wool	G30X03-072900	1
87	fan motor	G20A01-091501	1
88	cavity back insulation plate	G48R07-072201	1
89	48" regulator cover	G48X03-034401	1
90	power cord terminal cover	G36X03-031300	1
91	power cord terminal	G36X03-200200	1
92	power cord	G20A13-160100	1
93	ignition support	G36X03-212300	1
94	safety valve big support	G36X03-076600	1
95	relay	G36X03-190200	1
96	48" regulator	G48X03-034000	1
97	48" pressure adjustable valve fixed support	G48X03-034500	1
98	safety valve	G36X03-035000-1	3
99	5/8" corrugated pipe 300mm	G20C01-215302	1
100	48" cavity back gas manifold	G48X03-030801	1
101	anti-tip support X01 series	G36X01-212501	1
102	3/4" corrugated pipe 180mm	G36X03-215300	1
103	48" baffle plate	G48X03-072001	1
104	anti-wall rubber mat	G36X03-212600	2
105	48" baffle plate strengthen part	G48X03-072300	1
106	grill burner nozzle mount	G36X03-021100	1
107	grill burner nozzle NG 1.38	G36X03-021205	1
108	5/8" corrugated pipe 600mm	G20C01-215307	1
109	chimney component	G36R03-074100	3
110	chimney inner plate	G36R03-074100	3
111	LED light transformer	G36R04-180305	1
112	smoke outlet component	G36X03-075000-Z	3
113	18" cavity blue enameled back plate	G18X03-070301	1
114	lamp	G36X03-180100	3
115	front panel strip	G30X03-214500	1
116	18" front panel strip	G18X03-214500	1
117	grill burner	G36X03-090100	1

118	18" cavity back plate glass wool	G18X03-072900	1
119	grill burner reflect board	G36X03-090300	1
120	cavity top plate	G30X03-070600-Z	1
121	18" cavity top plate	G18X03-070600-Z	1
122	thermo-sensor fixed part	G36X03-031100	4
123	grill burner cover	G36X03-071600	1
124	48" cavity top glass wool	G48X03-036000	1
125	cavity structure frame glass wool	G48X03-070800	1
126	48" cavity insulation plate	G48R03-074500-Z	1
127	/	/	/
128	20,000btu burner	G36R03-040300	1
129	top burner spark plug 700	G36R04-170501	1
130	top burner support	G36R03-170600	7
131	15,000btu burner	G36R03-040100	4
132	top burner spark plug rear 660	G36R03-170501	4
133	9,000btu burner	G36R03-040000	3
134	top burner spark plug front 380	G36R03-170500	3
135	cooktop plate -1	G24R03-020100	1
136	48" cooktop plate decoration strip	G48R04-025000	1
137	48" cooktop plate	G48R03-020100	1
138	48" cast iron grates	G48R04-021400	1
139	cast iron grates	G36R04-021400	3
140	backsplash bolt	G36X03-110800	2
141	48" cooktop back connection plate	G48R04-073600	1
142	48" backsplash component	G48R04-011500-Z	1
143	griddle	G36R03-021400	1
144	pan support	G48R03-021400	1
145	knob for thermostat 1to 1	G36R04-030102	1
146	knob for thermostat 1to 2	G36R04-030103	1
147	knob for single gas outlet	G36R04-030100	7
148	knob for double gas outlets	G36R04-030101	1
149	knob ring R04	G36R04-030200	10
150	knob shining PCB	G36R04-031000	10
151	48" switch with lock-red	G48X03-170200	3
152	48" control panel	G48R04-030301	1
153	/	/	/
154	48" control panel inner plate	G48R04-032300-Z	1
155	red indicator	G36X03-031000-7	2
156	red LED light	G36X04-031000-7	10
157	magic eye switch	G36R04-170200	1

158	ignition	G36R03-170100	8
159	48" cooktop front support	G48R03-022100	1
160	digital thermostat KKXT-18-48	G36X03-030900-1	1
161	48" cooktop back support	G48R04-022000	1
162	top valve 0.67	G36X03-030403	4
163	main gas valve 0.68 & 0.27	G36R04-030400	1
164	R/F main Al. pipe	G36R03-020500	1
165	R/F support Al. pipe	G36R03-020600	1
166	R/R Al. pipe	G36R03-020400	4
167	48" control panel gas manifold	G48R04-030700	1
168	48" digital thermostat KKXT-17-48	G48X03-030900-1	1
169	top valve 0.57	G36X03-030401	3
170	top valve support	G36X03-030500	8
171	L/F Al. pipe	G36R03-020700	1
172	M/F Al. pipe	G36R03-020300	2
173	R/M/R Al. pipe	G48R05-020400	1
*	nozzle 0.46	G20A01-021235	1
*	nozzle 0.9	G20A01-021203	2
*	nozzle 0.93	G20A01-021222	3
*	nozzle 0.94	G20A01-021236	1
*	nozzle 1.18	G20A01-021237	4
*	oven burner nozzle LP 1.39	G18X03-021207	1
*	48" nozzle 1.12	G48X04-021209	1
*	48" carton	G48R05-230100	1
*	door component	G30R03-100001-Z	1
*	18" door component	G18R03-100000-Z	1